

Flowmatic Tubular 2030 Electronic Soap Dispenser Wall Mount

PRODUCT CODE:

- TZ-FLOWSOAP1



SPECIFICATIONS

- Touch-free electronic soap dispenser operated by infrared sensor.
- The soap dispenser automatically activates when users place their hands within sensor range, providing a measured amount of soap (adjustable by remote control).
- If the users remove their hand before the full amount is dispensed, the soap dispenser immediately stops the soap flow.
- Chrome plated assembly for durability and easy cleaning.

TECHNICAL DATA

Capacity	1 Litre
Power supply for battery versions:	Battery models: Battery Box for 6xD Alkaline batteries
Soap viscosity	100 – 3800 cPs
Standard discharge	1.4ml (customizable by optional remote control)
Sensor range:	35-155 mm +/- 10 mm (customizable by optional remote control)
Pre-set sensor range	80 mm +/- 10 mm
Finish	Chrome
<i>NOTE: Galvin Specialised continually strive to improve their products. Specifications may change without notice.</i>	

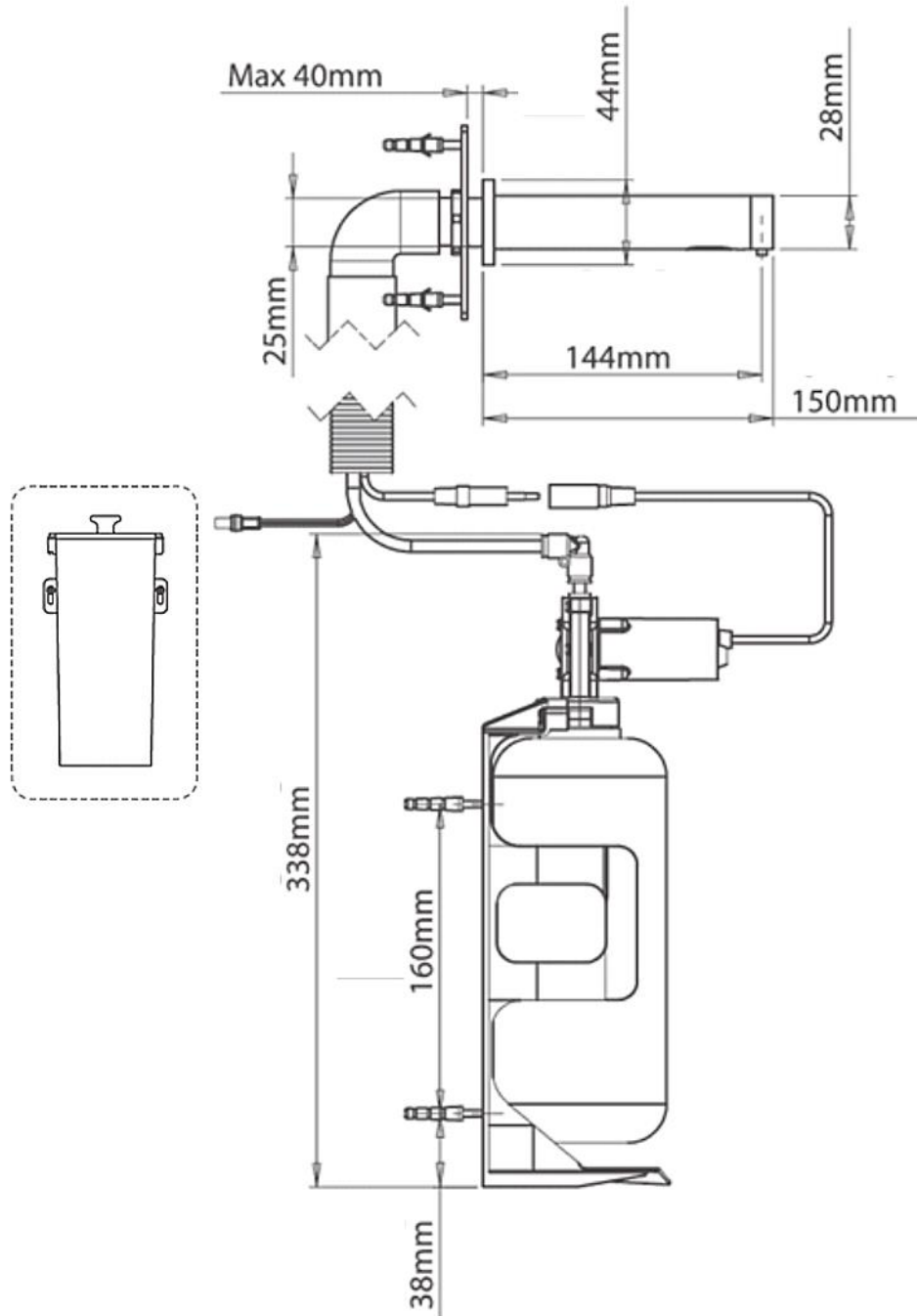



PACK CONTENTS

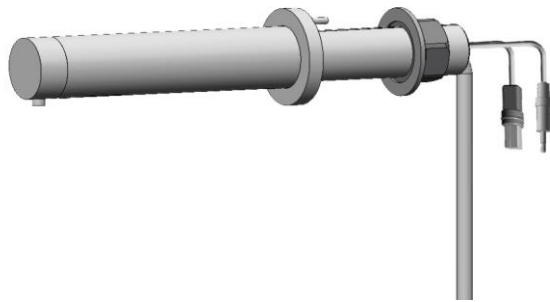

1 x Body assembly for Tubular Soap Dispenser



1 x Elbow and corrugated tube



1 x Wall rosette

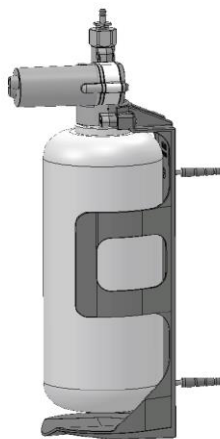

1 x Soap tank with bottle support and pump assembly



1 x Battery Box for 6xD Alkaline Batteries



1 x Temporary base cover



8 x Screws and Wallplugs



1 x Quick connection fitting



PRE-INSTALLATION

CHECK CONTENTS

- Separate all parts from the packaging and check each part with the pack contents section.
- Make sure all parts are present before discarding any packaging material. If any parts are missing, do not attempt to install your electronic faucet. Contact Galvin Specialised.

WARNINGS

- Do not install the system facing a mirror or any other electronic system operated by an infra-red sensor.
- To prevent reflection problems, it is recommended to keep a minimum distance of 300 mm between the soap dispenser and any other objects.

IMPORTANT:

- Keep in mind that when using the faucet installed next to the soap dispenser, the user hands should not interfere with the soap dispenser sensor detection area. Liquid soap dispensers, with proper care, will provide long term trouble free service. Quality liquid soap of recommended viscosity and pH levels are the main factors for smooth operation of your dispenser. If needed, use a viscometer to verify the viscosity of your soap to ensure maximum benefit. The recommended range for liquid soap viscosity is 100-3800 cPs. Thicker liquid soap flows slower and inhibits the pump valve, causing strain and damage.
- Liquid soap dispensers are suitable for use with any generic liquid soap of the correct viscosity and pH. The pH level of all soap used in our liquid soap dispensers should be between 6.5 to 8.5. Lower levels will cause corrosion to the metal dispenser and even the rubber and plastic components. Higher pH levels will cause swelling to rubber parts and degradation of plastic components over time.

INSTALLATION

IMPORTANT: Galvin Specialised products must be installed in accordance with these installation instructions and in accordance with your local regulatory requirements. Electrical supply conditions must also comply to the applicable national and/or state standards. Failing to comply with these provisions shall void the product warranty and may affect the performance of the product.

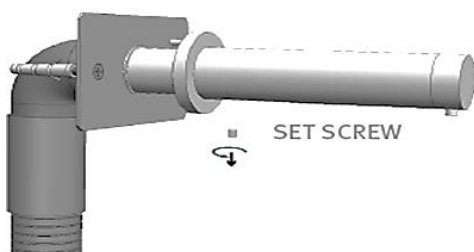

1. Drill hole & Disassemble body

- Drill a hole (23 to 24 mm) at the desired location for the soap dispenser spout installation.
- Remove the hexagonal nut and the disk from the base of the soap dispenser spout.
- Disconnect the soap dispenser body with the rosette from the base by unscrewing the grub screw.

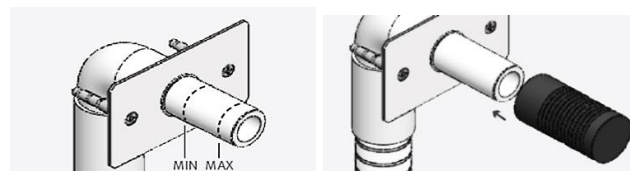

2. Mount Soap Dispenser

- Mount the soap dispenser base into the opening in the wall and secure it using the anchors provided in the package.
- **IMPORTANT:** The soap dispenser base should be installed so that the outside surface of the finished wall falls between the minimum and maximum lines marked at the base.
- Assemble the temporary protective soap dispenser base cover.

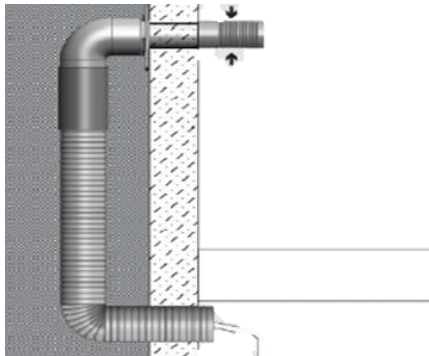

3. Assemble corrugated tube:

- Assemble the corrugated tube to the soap dispenser base.
- Ensure corrugated tube is kept in place whilst tiling.
- Insert the wall rosette through the soap dispenser base.

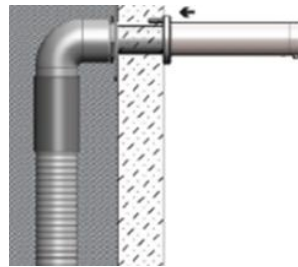

4. Assemble spout:

- Cut / remove the temporary soap dispenser base cover.
- Fix the soap dispenser spout by inserting the nipple into the soap dispenser base and then tightening the screw.
- Remove the protective sticker covering the sensor. Keep away from the sensor range and check that no objects are in front of the sensor.
- Pull the two points connector, soap dispensing tube and the power supply connector out of the soap dispenser base, and through the corrugated tube.

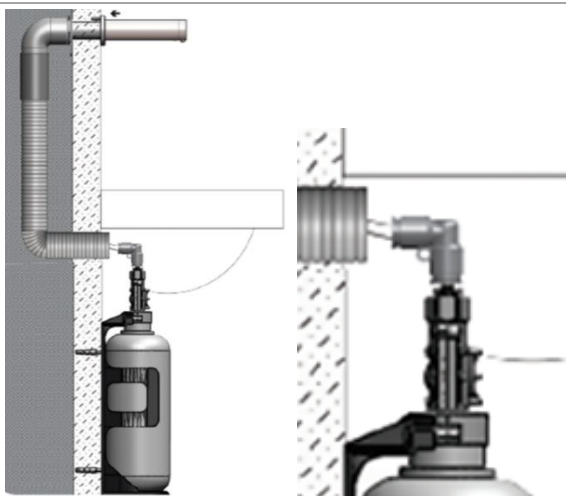

5. Soap bottle:

- Install soap bottle support assembly using screws and wallplugs provided.
- Connect soap dispensing tube to soap bottle using Quick connecting fitting supplied in packaging.

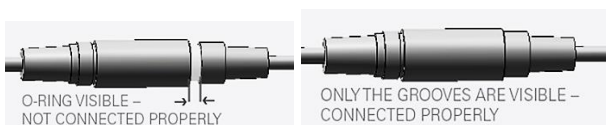

- Connect the soap pump connector to the matching connector from the sensor.

FROM THE SOAP DISPENSER

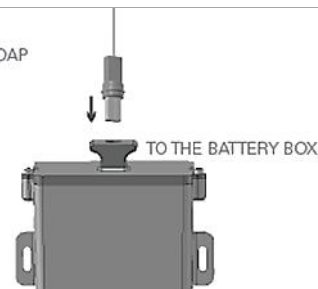

6. Battery box:

- Open battery box by unscrewing screws on the lid and insert 6xD Alkaline Batteries in battery box.
- Close the lid and tighten the screws.
- Install the battery box on the wall underneath the sink using screws and wallplugs provided.
- Connect the battery connector.



ABOUT
10
SECONDS

7. Test:

- Wait about 10 seconds before you put your hands within the sensor range to avoid entering the adjustment mode.
- Test the soap dispenser.



Product Installation Guideline

Version 1, 17 March 2021, Page 6 of 12

- **IMPORTANT:** The connector should be connected properly so that the white O-ring is not visible and a clicking sound is heard.

FILLING THE SOAP TANK

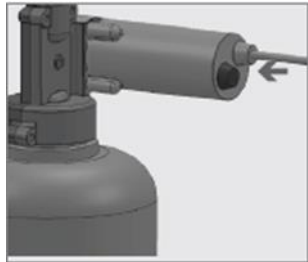
1.	Unscrew the soap tank from the pump assembly and pull it out from the bottle support.	
2.	Fill the liquid soap up to the top line.	
3.	Insert the bottle back into the bottle support.	
4.	Screw the soap tank back into the pump assembly. Make sure the tank is firmly secured into place.	

<p>5. Press the refill button located at the back of the pump assembly until soap starts coming out of the soap dispenser spout. This operation can also be done using the soap dispenser remote control Refill function.</p> <p>Note : Once the soap in the soap tank has reached the bottom line the soap tank should be refilled. To refill the soap tank please refer to steps 1-5.</p>	 
---	---

REMOTE CONTROL FUNCTIONS (SOLD SEPARATELY)

The soap dispenser remote control can adjust the dispenser's settings. To use the remote control hold it in front of the sensor at a distance of 10-15cm (4-6").

Attention: The remote control will not operate out of the recommended range (too close or too far).

The remote control can be used to adjust the following functions:

1-SOAP QUANTITY

The 1-4 drop keys allow the user to choose the desired soap quantity.

0.7 to 0.9cc	1.2 to 1.6 cc	1.6 to 1.9 cc	2.1 to 2.3 cc *
--------------	---------------	---------------	-----------------

Indication: continuous blinking of the light in the sensor eye.

2-ADJ

This function resets the sensor back to factory settings. Indication: 2 blinks of the light in the sensor eye.

3-TEMPORARY OFF FUNCTION

This function temporary disables the dispenser. Use this function to perform maintenance in front of the sensor without activating the system (for example: cleaning).

The soap dispenser will shut off for one minute after this button is pressed once. To return to normal operation before the minute is over, press the On/Off button again. Indication: OFF – 2 fast blinks, ON – 4 fast blinks

4-FILL THE SOAP TANK



Once the soap tank has been filled \ refilled, press the FILL button. The pump will run for one minute, priming the piping with soap. Once soap begins dispensing from the spout, priming is complete. Press the FILL button again to stop the priming before the minute is over.

Indication: continuous solid light in the sensor eye.



BATTERY REPLACEMENT

Battery models only

When the battery requires replacement, the red indicator light will blink at a constant rate when the user's hands are within the sensor range. The battery must be replaced within two weeks.

To replace the battery in battery models:

1. Carefully open the battery box, use a 2.5 mm Allen key.
2. Remove the old batteries.
3. Replace the used batteries with new D batteries.
4. Close the box.

NOTE: Do not mix used batteries with new ones.

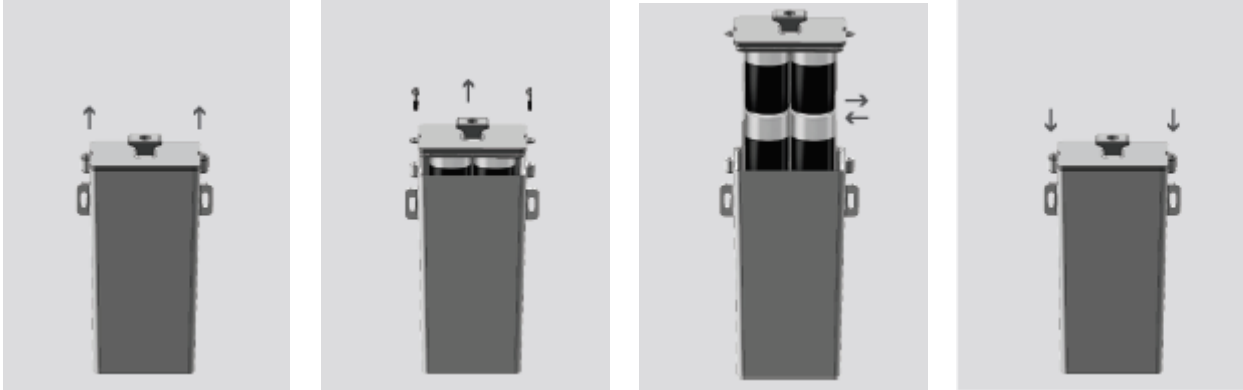

Important: Spent batteries should not be disposed of with normal household waste. Contact your local authority for information on waste disposal and recycling.



MAINTENANCE

Care and cleaning of chrome and special finishes

DO NOT use steel wool or cleansing agents containing alcohol, acid, abrasives, or the like. Use of any prohibited cleaning or maintenance products or substances could damage the surface of the soap dispenser. For surface cleaning use ONLY soap and water, then wipe dry with a clean cloth or towel. When cleaning bathroom tiles, the soap dispenser should be protected from any splattering of harsh cleansers.

Disassembling the soap pipe from the pump.

The soap pipe can be disconnected from the soap pump by a simple slide & pull action. The sliding ring of the quick connection fixation nipple on the pump should be pulled down. It releases the open end of the soap pipe which can then be easily pulled out.





Clean the soap tank.

Clean out the tank prior to refill by flushing warm water through the hoses and pump until clean water is released from the spout. TIP: Keeping a spare tank will enable this process to be completed in a speedy and hygienic manner with minimal downtime

TROUBLESHOOTING

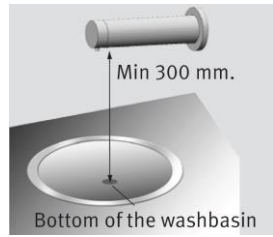
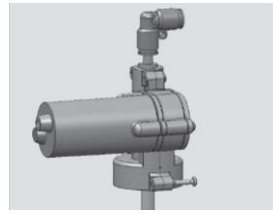
PROBLEM	CAUSE	SOLUTION	ILLUSTRATION
Continuous discharge from the nozzle	AUX connector not fully inserted	The connector should be inserted fully until white O-ring is not visible. Remove the O-ring if necessary	

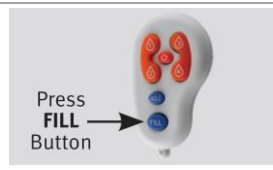
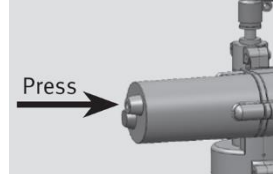
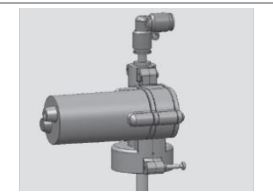

			
Random discharge from the nozzle	Reflection issue from basin or other object	Eliminate any cause of reflection and if necessary, use appropriate remote control to shorten detection range.	
Soap discharging from pump housing.	Damaged pump due to high viscosity or debris in pipes	Replace the Pump. Rinse warm water through the pipe and the body of the soap dispenser all the way to the nozzle.	
Soap is not discharging	Soap tank is empty	Fill with soap with correct viscosity (100 - 3800cPs) and prime pipes using the fill button on remote control.	
	Soap dispenser has not been primed	Prime the soap dispenser by pressing the fill button on the remote or by pressing the refill button located at the bottom of the pump, until soap exits the nozzle.	 
	Damaged pump (discharge from housing)	Replace the Pump	
	Debris or dried soap in the pipe or tank	Run warm water through pipe, pump, and body all the way to the nozzle. Replace with soap of correct viscosity.	
	High viscosity soap (> 3800 cPs)	NOTE: Using the soap dispenser with high viscosity soap may cause permanent damage to the pump and shorten the lifecycle.	

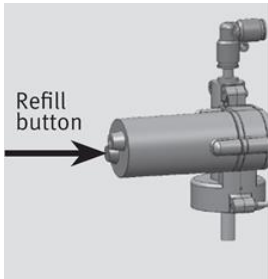
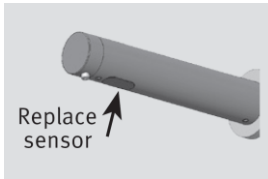
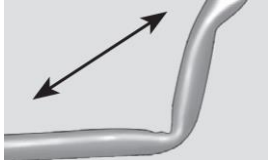
	<p>Refill button on pump does not activate the pump.</p>	<p>Check operation with functioning battery pack. Where necessary, replace batteries or replace the battery pack: Battery pack (without batteries)</p>	 <p>Refill button</p>
	<p>Damaged sensor</p>	<p>If the sensor is not even after changing batteries then resolve this issue by replacing sensor.</p>	 <p>Replace sensor</p>
	<p>Bent pipes</p>	<p>Unbend or straighten pipes.</p>	

WARRANTY

The warranty set forth herein is given expressly and is the only warranty given by the Galvin Engineering Pty Ltd. With respect to the product, Galvin Engineering Pty Ltd makes no other warranties, express or implied. Galvin Engineering Pty. Ltd. hereby specifically disclaims all other warranties, express or implied, including but not limited to the implied warranties of merchantability and fitness for a particular purpose.

Galvin Engineering Pty Ltd products are covered under our manufacturer's warranty available for download from www.galvinengineering.com.au Galvin Engineering Pty Ltd expressly warrants that the product is free from operational defects in workmanship and materials for the warranty period as shown on the schedule in the manufacturer's warranty. During the warranty period, Galvin Engineering will replace or repair any defective products manufactured by Galvin Engineering without charge, so long as the terms of the Manufacturer's warranty are complied with.

The remedy described in the first paragraph of this warranty shall constitute the sole and exclusive remedy for breach of warranty, and Galvin Engineering Pty Ltd shall not be responsible for any incidental, special or consequential damages, including without limitation, lost profits or the cost of repairing or replacing other property which is damaged if this product does not work properly, other costs resulting from labour charges, delays, vandalism, negligence, fouling caused by foreign material, damage from adverse water conditions, chemical, electrical or any other circumstances over which Galvin Engineering has no control. This warranty shall be invalidated by any abuse, misuse, misapplication, improper installation or improper maintenance or alteration of the product.

